

1st Floor

| | |
|----|---|
| 1 | La Farm Bureau |
| 2 | Trade Construction Company |
| 3 | Franciscan Missionaries of Our Lady Health System |
| 4 | Postlethwaite & Netterville |
| 5 | Triad Electric & Controls |
| 6 | Schlumberger |
| 7 | D.R. Horton |
| 8 | PEC Safety |
| 9 | DXC Technology |
| 10 | Sigma Engineers & Constructors |
| 11 | Allpax |
| 12 | Not Rocket Science |
| 13 | Vivint.SmartHome |
| 14 | Smittys Supply |
| 15 | Performance Contractors |
| 16 | Blue Cross & Blue Shield of LA |
| 17 | Bernhard MCC |
| 18 | Performance Software |
| 19 | Ochsner Health System |
| 20 | Laitram |
| 21 | GBRIA |
| 22 | Barrier Construction Co. |
| 23 | PayStar |
| 24 | Associated Grocers |
| 25 | Southland Steel Fabricators |
| 26 | Champion Technology Services |

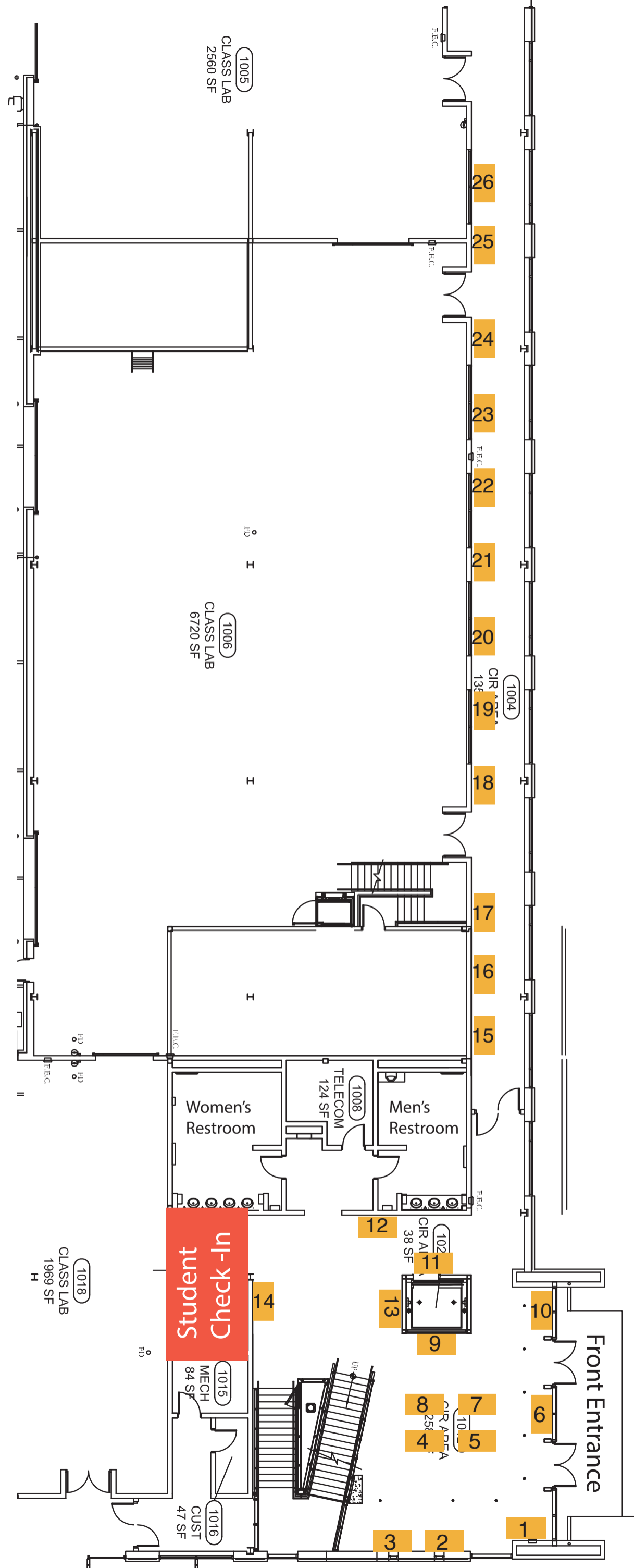

2nd Floor

| | |
|----|-----------------------------------|
| 27 | PALA Group |
| 28 | North Oaks Health System |
| 29 | Southeastern Office of Technology |
| 30 | Vinformatix |
| 31 | Process Pumps & Equipment |
| 32 | CGB Enterprises |
| 33 | Perficient |
| 34 | Weeks Marine |
| 35 | Turner Construction Company |
| 36 | Southeastern MBA Program |
| 37 | Southeastern ISAT Program |
| 38 | Netchex |
| 39 | Envoc |
| 40 | Ampirical Solutions |
| 41 | Gainey's Concrete Products |
| 42 | AMERISAFE |
| 43 | CGI |
| 44 | Arkel International |
| 45 | Entergy |

